

GLEBE ROAD: LAKESHORE

HARD MATERIALS

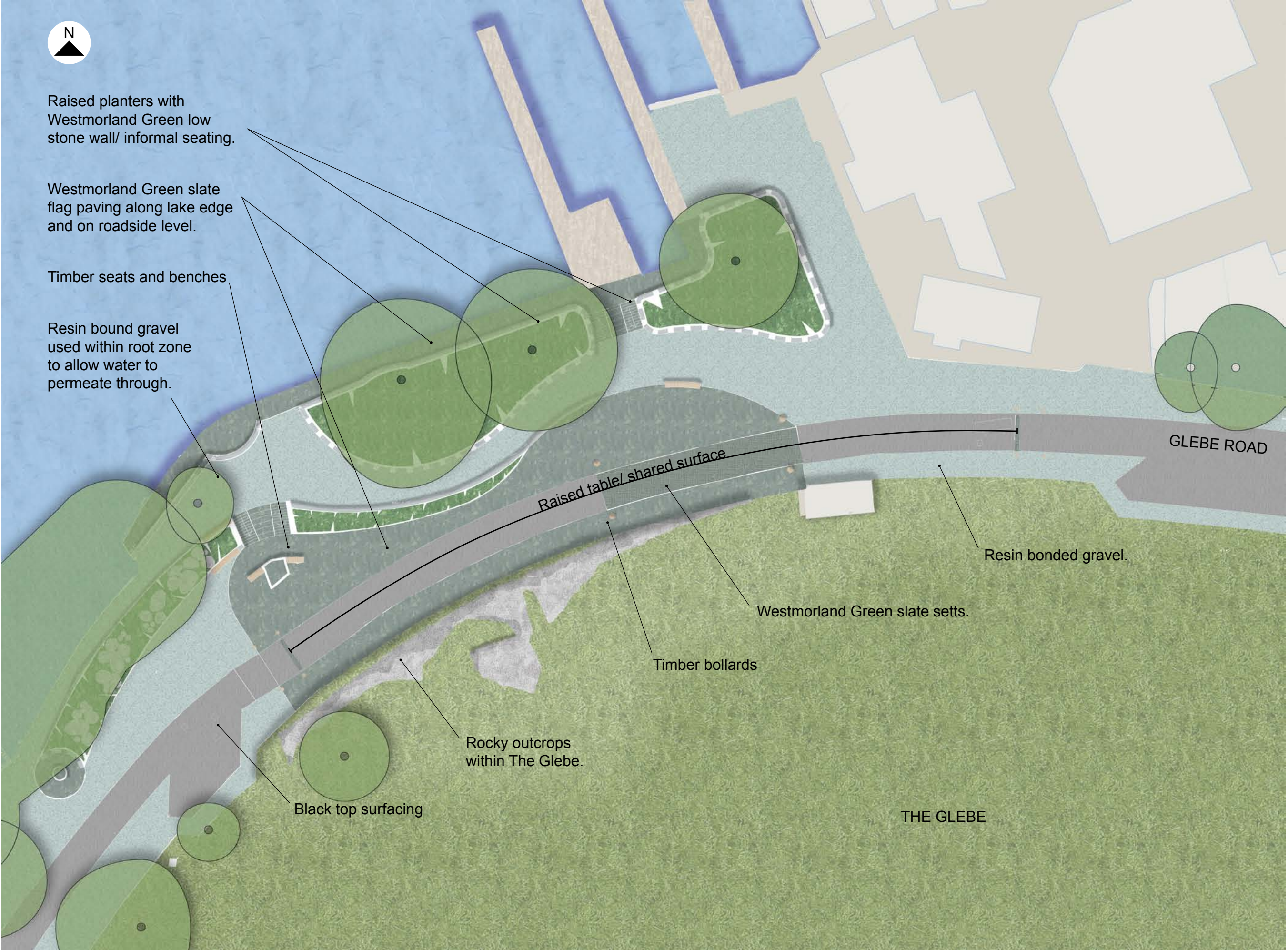

Plan view of proposals at Glebe Road lakeshore.

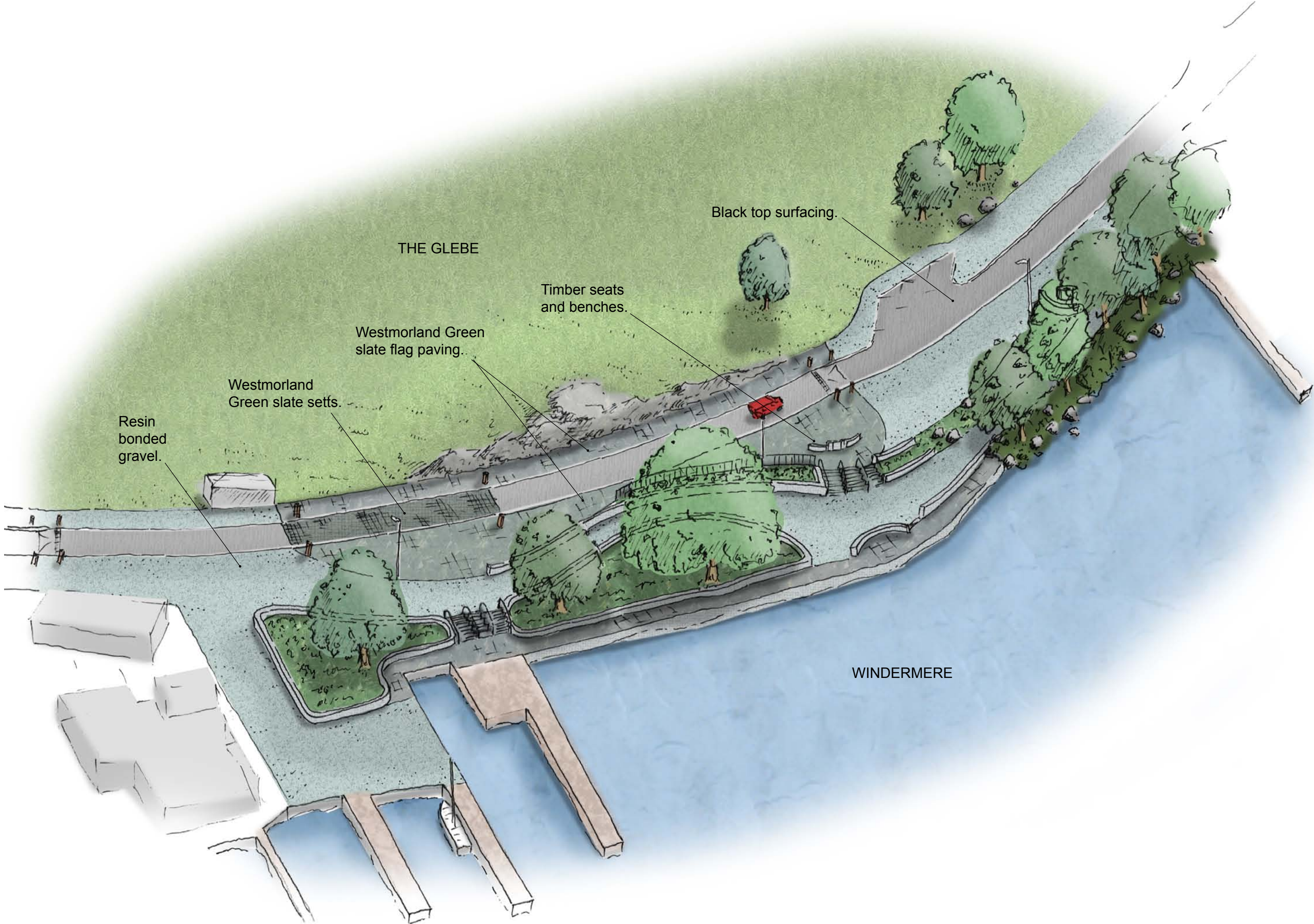

Axonometric sketch view of proposals at Glebe Road lakeshore.



Westmorland Green slate paving flags (shown here as sample only - not laid).flamed finish.



Westmorland Green slate setts, tumbled finish.



Cumbrian Black slate setts, tumbled finish.



Blister paving to be created in local slate flags, rather than granite as shown.



"Natural Green" resin bonded surface.



Conservation kerb unit.



Timber bollards.



Low wall around planting beds to be built from Westmorland Green walling stone.



Gabion cages filled with local walling stone as an option for low retaining walls.



Simple, contemporary timber bench option for top of stone planter edge.



Simple, contemporary timber bench option for top of stone planter edge.



Simple, robust timber bench with back and armrests.



Simple, contemporary timber litter bin option.



Standard South Lakeland Council litter bin.

GLEBE ROAD: LAKESHORE

SOFT MATERIALS



Ferns reflect local fell landscape and provide year-round colour.



Native foxgloves provide bursts of colour, structure and height.



Seasonal bursts of colour can be introduced through bulb planting under tree canopies.



Ivy provides robust, evergreen groundcover.



Bold drifts of grasses and perennials will help to provide further seasonal interest.



Wildflower mixes provide colour and nectar rich species ideal for wildlife.



Grasses provide movement, seasonal interest and reflect lakeshore planting.



Grasses can provide a varied textures and forms to create a strong, simple design.

